

NOTE:

The flange-to-flange dimension is 1/2" larger than the outside dimension of curb, unless directed otherwise

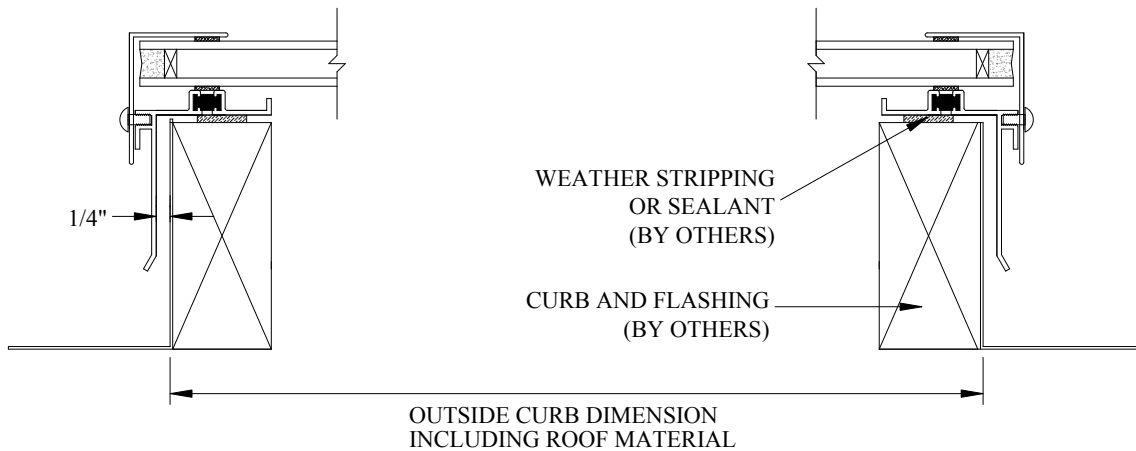

CURB MOUNT-GLASS; THERMALLY BROKEN - Specification:

Curb Mount-Glass; Thermally Broken, as manufactured by **ORCA Manufacturing, Inc.**, with insulated glass unit (Clear tempered over tempered standard, Low-E, tinted or laminated as an option) in a welded thermally broken, extruded aluminum sash. Finish in bronze, (or white gloss enamel as an option).

Model: A x B CMG-TB, [Glz], [Finish]



TITLE: CURB MOUNT-GLASS; THERMALLY BROKEN

Date: May 01, 2003

Drawn By: AP Sheet:

Rev. By: CRH 1 of 1

Engineer: CRH

ORCA Manufacturing, Inc.
P.O. Box 2186
Easton, MD 21601
Phone: 800-776-1539